

**582 Milton Turnpike 0
Marlboro
\$490,000**

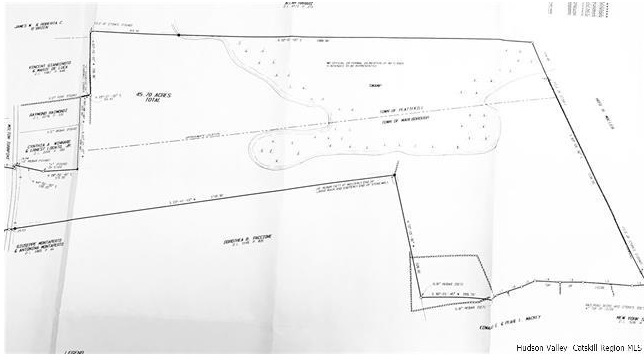

LOT **SUB DIVIDABLE, WETLAND,**
FEATU **WOODED**

RES
LOT **RURAL**

/SITE
School **\$3,132**

Tax
General **\$1,503**

Tax
Remarks **Great potential for individual
homestead or possible
subdivision. 32 acres located in
the Town of Marlboro and 14.5
acres in the Town of Plattekill.
There has been engineering done
for a possible subdivision.**

MLS # **20204067**
Class **LOTS/LAND**
Type **Residential**
Area/Town **MARLBORO**
Number of Acres **46.50**
School District **MARLBORO**



**Summerset Realty
Main: 845-691-6950
3669 Route 9W
Highland NY 12528
summersetrealty@aol.com
www.summersetrealty.com**

